

Commune d'ALBI (81)

Chemin de Gaillaguès

Lotissement " Hameau de Gaillaguès "

PLAN DE VENTE DU LOT N°5



S = 525 m² - Section ES n° 269p(e)

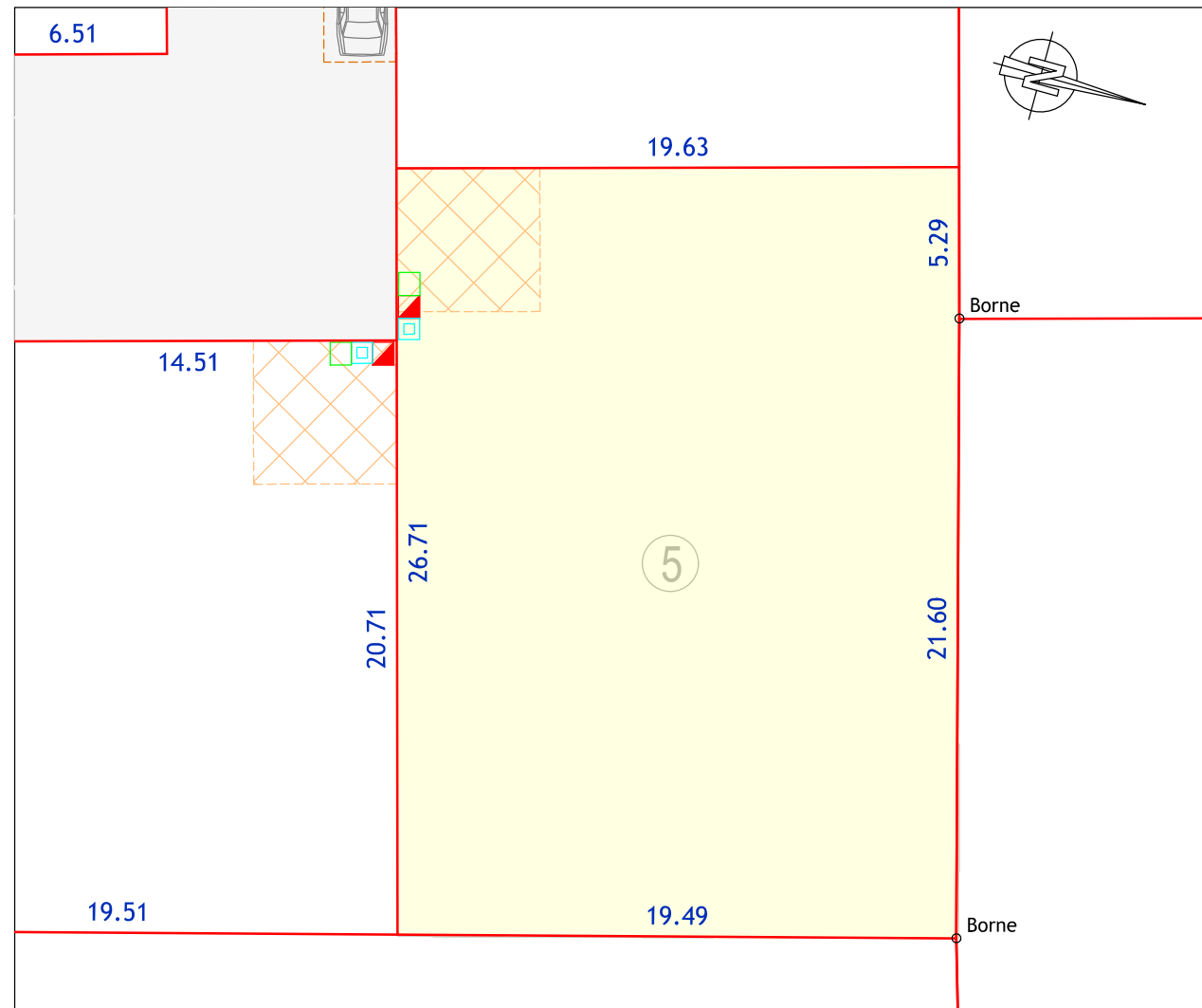

APRIM
AMÉNAGEUR & PROMOTEUR IMMOBILIER



LEGENDE :

-  Limite des lots privés
-  Aire de stationnement privative
-  Borne ou repère

Échelle : 1 / 250

Plan d'ensemble

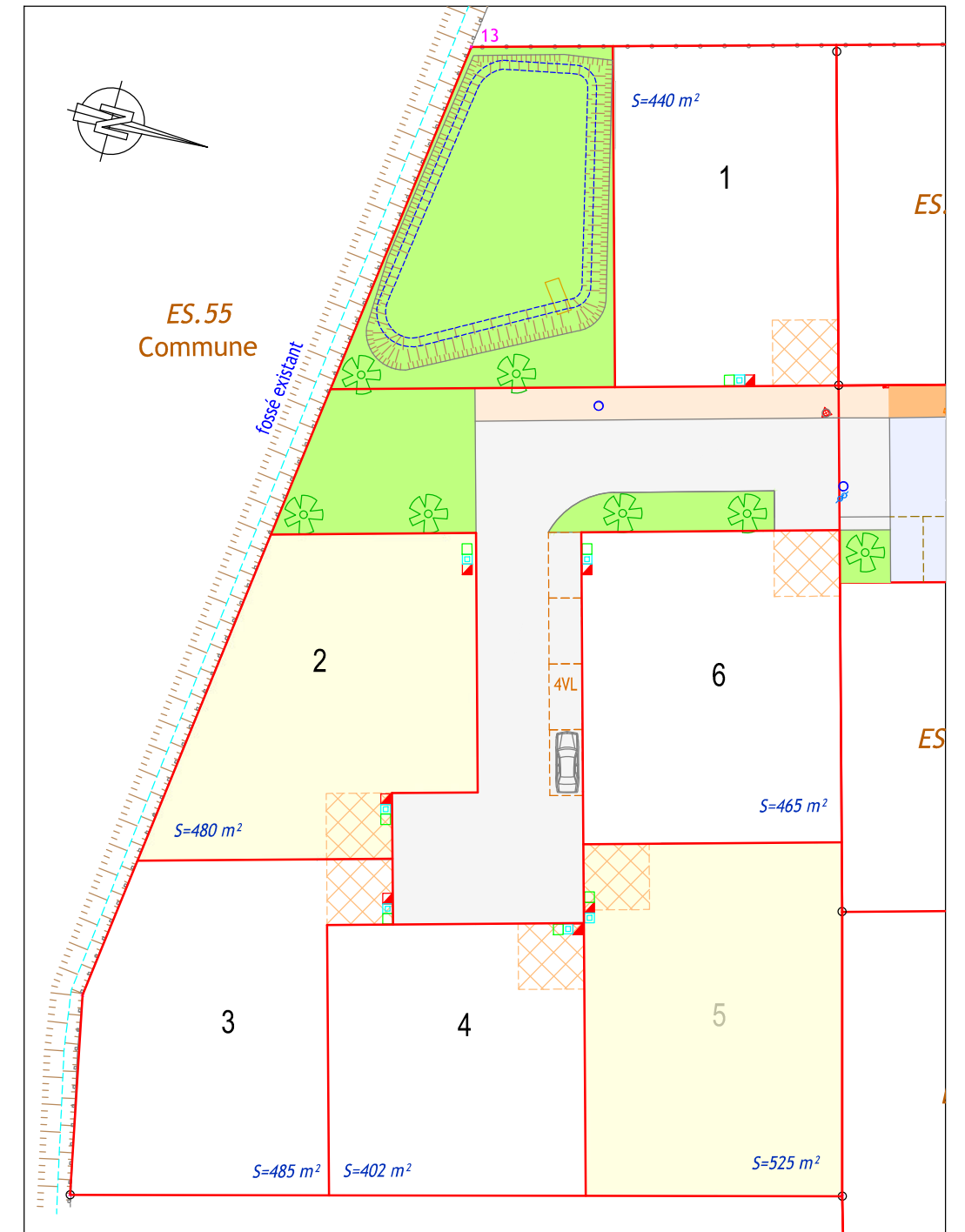

Échelle : 1 / 500